

STEX ADVANCED DESIGN BUREAU -

ALL RIGHTS AND INTELLECTUAL PROPERTY RIGHTS RESERVED [2016]

<http://WWW.STEXINTERNATIONAL.COM>

Variation 2: A 42 Feet x 42 Feet - Single Ground Floor House : 1764 Sq Feet — 5 Bedroom Configuration

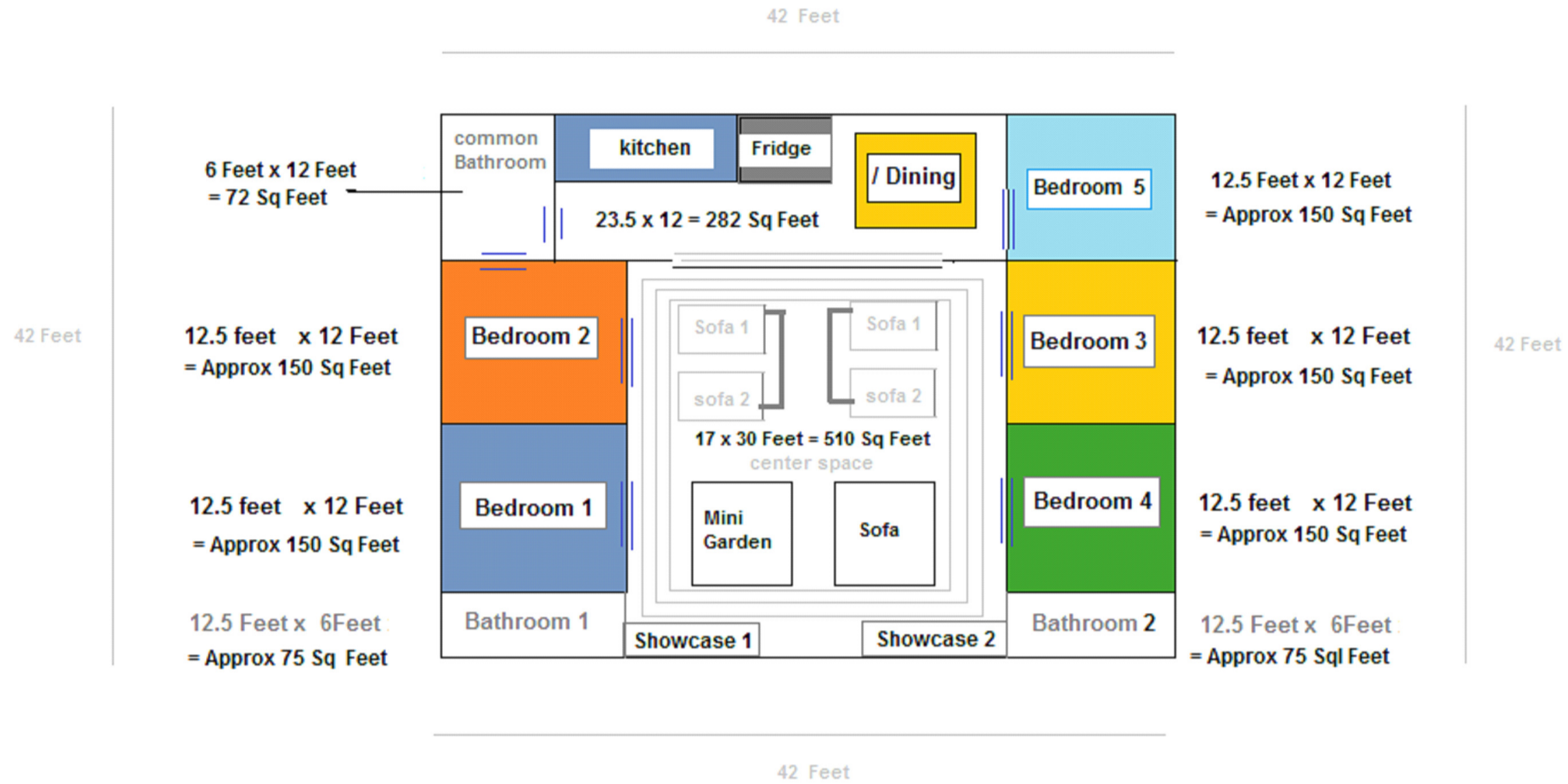

STEX ADVANCED DESIGN BUREAU - ALL Rights Reserved

Housing Architecture - Model II [Type H]- 42 Feet X 34 Feet = 1428 Sq Feet

[Configuration : 5 Bedroom + Swimming Pool] : For Homes /Resorts/Hotels

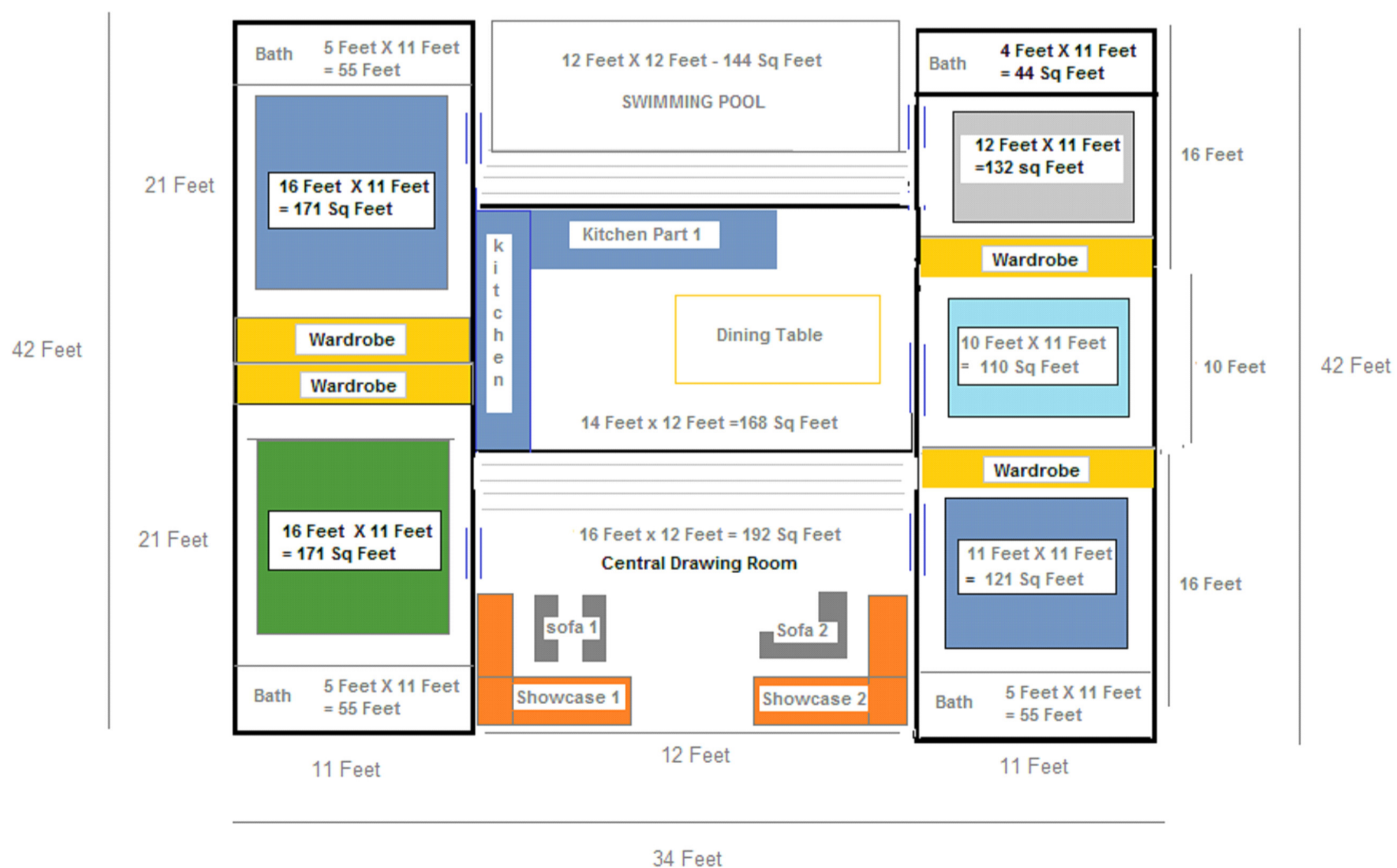

Note in this configuration the

Central Drawing Room can be Made 18 Feet x 12 Feet = 216 Sq Feet

The Kitchen can be made 16 Feet x 12 Feet = 192 Sq Feet

And the swimming pool size can be reduced to 8 Feet x 12 Feet = 96 Sq Feet [This approach is called Freescaling].